

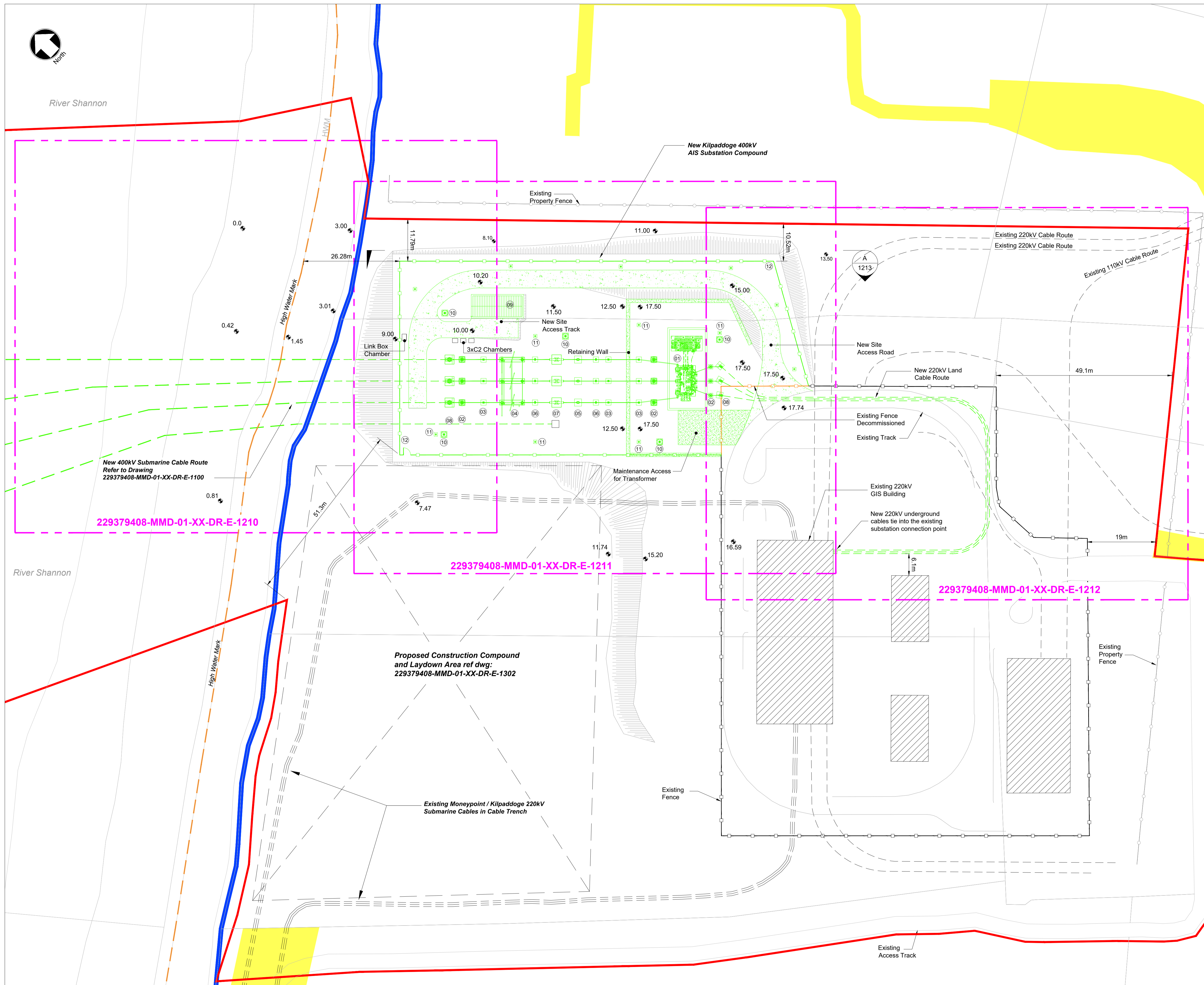

River Shannon



Notes

- For planning purposes only.
- All dimensions are in metres unless otherwise noted.
- All levels are in meters above Malin Head Datum.

Key to symbols

- Application Site Boundary
- Related Landholding
- New Equipment
- Existing Equipment
- Existing Equipment - To be Decommissioned
- New Submarine / Underground Cable
- High Water Mark
- Wayleave
- Existing Building

Equipment Schedule	
Item	Description
01	Power Transformer
02	Surge Arrestor
03	Post Insulator
04	Disconnect / Earthing Switch
05	Current Transformer
06	Voltage Transformer
07	Circuit Breaker
08	Cable Sealing End
09	Control Building
10	Lightning Monopole (25.0m)
11	Light Pole (9.0m)
12	Palisade Fence (2.6 m)

Scale: 1:500

Reference drawings

229379408-MMD-01-XX-DR-E-1100	Shannon 400kV Cable-Sub-Sea Cable Overall Plan Layout
229379408-MMD-01-XX-DR-E-1210	Kilpaddoge 400kV AIS Substation - Plan Layout Sheet 1 of 3
229379408-MMD-01-XX-DR-E-1211	Kilpaddoge 400kV AIS Substation - Plan Layout Sheet 2 of 3
229379408-MMD-01-XX-DR-E-1212	Kilpaddoge 400kV AIS Substation - Plan Layout Sheet 3 of 3
229379408-MMD-01-XX-DR-E-1213	Kilpaddoge 400kV AIS Substation - New Transformer Bay - Section

PL1	10.07.2020	CHC	Issued for Planning	DMcC	TK
Rev	Date	Drawn	Description	Ch'k'd	App'd

MOTT MACDONALD

South Block
Rockfield
Dundrum
Dublin 16
Ireland
T +353 (0)1 291 6700
F
W www.mottmac.com

EIRGRID

Title
Capital Project 0970
Cross Shannon 400 kV Cable Project
Kilpaddoge 400kV AIS Substation
Overall Plan Layout

Designed	B. Zulueta	Eng check	D. McCormack
Drawn	C. Cunningham	Coordination	E. Halpenny
Dwg check	D. Hassett	Approved	T. Keane

Scale at A1: 1:500 Status: PRE Rev: PL1 Security: STD

Drawing Number: 229379408-MMD-01-XX-DR-E-1200

© Mott MacDonald Ireland
This document is issued for the party which commissioned it and for specific purposes connected with the captioned project only. It should not be relied upon by any other party or used for any other purpose.
We accept no responsibility for the consequences of this document being relied upon by any other party, or being used for any other purpose, or containing any error or omission which is due to an error or omission in data supplied to us by other parties.
© Ordnance Survey Ireland/Government of Ireland.
Ordnance Survey Ireland Licence No. EN0061519-24